



Technical specifications



Contents

Technical data	2
Construction.....	3
Sails and rigging.....	3
Hardware.....	3
Mooring and anchoring	3
Engine.....	4
Plumbing.....	4
Electrical	4
Deck layout.....	5
Windows, openings and ventilation	6
Interior layouts	6
3 cabin 3 bathroom version.....	8
4 cabin 4 bathroom version	12

Technical data

Length overall	12.80 m / 42'
Length	12.50 m / 41'
Maximum beam	7.70 m / 25'3"
Air draft	20.65 m / 67'9"
Draft	1.25 m / 4'1"
Displacement (CE)	12.1 t / 26,681 Lbs
Upwind sail area (std mainsail)	90 m ² / 968 sq.ft.
Upwind sail area (square top mainsail)	94 m ² / 1011 sq.ft.
Fully battened mainsail	55 m ² / 592 sq.ft.
Square top mainsail (option)	59 m ² / 635 sq.ft.
Self-tacking jib	35 m ² / 377 sq.ft.
Code 0 (option)	68 m ² / 732 sq.ft.
Fresh water capacity	300 L / 79 Us Gal
Fuel capacity	300 L / 79 Us Gal
Engines	2 x 45 hp CR to 2 x 57 hp CR
Architects	VPLP Design
Exterior design	Patrick le Quément
Interior design	Nauta Design
Number of berths	6 to 12
CE Certification	A : 12 – B : 14 – C : 20 – D : 30

NORTH AMERICAN SPECIFICATIONS

Only for boats sold in US

- 120V Electric panel and electric equipment
- US 120V outlets
- Gas propane circuit with solenoid valve

Construction

- Polyester and high quality anti-osmotic resin
- Hull and deck and coachroof laminated by infusion
- Balsa core hull, white gel coat
- Balsa core bridge deck and deck
- Laminated or glued plywood bulkheads

Sails and rigging

SAILS

- 1 high roach mainsail in Dacron with battens
- 1 self-tacking jib in Dacron with UV protective band on furler,

STANDING RIGGING

- Anodized aluminum mast with mainsail ball bearing track system
- 1 level of spreaders
- Anodized aluminum boom
- 2 encased shrouds
- 2 shroud chainplates
- 2 forestay chainplates
- 1 self-tacking jib forestay with furler
- Lazy-jack adjustable on cleat at the foot of the mast
- Deck light on the mast

RUNNING RIGGING

- 1 double purchase Spectra mainsail halyard
- 1 Spectra self-tacking jib halyard
- 1 pre-stretched mainsail sheet
- 1 pre-stretched self-tacking jib sheet
- 3 reefing lines (1st Dyneema)
- 1 pre-stretched self-tacking jib furling line
- 2 pre-stretched mainsail traveler car control lines

Hardware

- 2 manual winches 46.2 STA
- 1 mainsail track with ball-bearing car
- 1 self-tacking jib track
- Anodized aluminum crossbeam with fixing point for the self-tacking jib furler, anchor roller
- Navigation lights on the forward decks and at the back of the coachroof

Mooring and anchoring

- Composite longitudinal crossbeam with integrated chain run and mooring cleat
- 8 mooring cleats
- 1000W / 12V electrical windlass with vertical axis, gypsy (chain 10mm)
- Access to windlass and to anchor locker

Engines

- 2 diesel engines YANMAR 4JH45 45hp common rail saildrive
- Fixed two blade propeller
- Raw water filter
- Mechanical engine throttles at the helm station
- Engine compartment ventilation : electrical extraction in the aft transom
- Fuel circuit:
 - 1 rotomolded 300L / 79 US gal tank (+300L with the essential equipment in the port cabin under the floor)
 - Fuel filter systems
 - Fuel shut off valve
 - Gauge at the general control panel on touch screen
- Access to the engine compartments from the transom through hatches

Plumbing

FRESH WATER CIRCUIT

- 300L / 79 US gal fresh water tank
Gauge at the general control panel on touch screen
- Fresh water circuit with 1 main water group in the aft port engine compartment
- 40L / 11 US gal electric water heater, 230V/engine exchanger

GREY WATER

- Shower and sink draining by automatic water sensor with timer

BLACK WATER

- 3 cabin 3 head version: 3 tanks 80L / 21 US gal (total 240L / 63 US gal)
- 4 cabin 4 head version: 4 tanks 80L / 21 US gal (total 320L / 85 US gal)

BILGE PUMPS CIRCUIT

- 1 manual bilge pump with cockpit pump per hull
- 1 automatic immersed bilge pump per hull
- 1 manual release non-immersed bilge pump per hull

Electrical

POWER CIRCUIT DC – 12V

- 2 alternators 12V - 125A
- 2 start batteries 12V - 110A
- 2 service batteries 12V - 140Ah (acid)

Battery circuit breaker in the engine compartments (just below the hatches)

ELECTRIC DISTRIBUTION PANEL

- 12V General distribution panel at the chart table with protection by circuit breaker
- Ammeter, voltmeter, circuit breaker, panel lighting
- USB sockets 12V included in the electrical panel

LIGHTING

- Recessed 12V LED spotlights in ceiling
- 12V LED reading light next to bunks
- 12V LED chart table light
- 12V lighting in engine compartment
- LED navigation lights

Deck layout**TRANSOM**

- Hot/cold deck shower on starboard
- S/s telescopic swim ladder with fixed handle on starboard
- Small storage on the sides of the transom

AFT COCKPIT

- Cockpit usable as a deck saloon, protected by a hard top bimini
- L-shaped bench with 1 storage locker and 10 kg / 22 lb gas bottle under the seat
- Removable polyester cockpit table 6/8 people (1400x820mm / 4'7"x2'8")
- Storage locker on portside (cockpit fridge or ice maker option)
- Lounger on port side with storage locker
- Polyester fiddle anti-runoff on the sides of the cockpit
- Access to the engine compartments through hatches with gas struts
- Aft crossbeam with stainless steel backrest

HELM STATION

- Composite staircases to access from the cockpit
- Double stainless steel helm seat
- Leather covered stainless steel steering wheel diam. 800mm / 31in
- Console for screen and instrumentation
- Engine throttle and panel
- Cup holder
- USB outlet (included in the Navigation Pack option)
- Sheets bag on the starboard side of the helm station
- Winch handle holder
- Access to coachroof via a staircase with teak steps and s/s structure + handrail (bimini option)

FORWARD COCKPIT

- Large hatch on starboard with gas s/s struts and locker for the access to the fresh water tank
- Locker on portside with gas s/s struts (300L / 79 US gal) additional fresh water tank or generator option)
- Trampoline (nylon)

BOW LOCKERS

- Access through opening deck hatches with locker (T60 - 507x507mm / 1'8"x1'8")
- Lighting
- Grey painting
- Inboard side porthole (347x171mm / 1'2"x 7in) (if berth option)

STANCHIONS AND LIFE LINES

- Pushpits with flag support
- Stanchions: H 610mm / 24in
- Double lifelines

Windows, opening and ventilation

- Sliding door
- Deck hatches:
 - Deck hatch T10
 - Deck hatch T44
 - Deck hatch T60
- Hull portholes
 - Fixed PMMA portholes with integrated openings

Interior layouts

GENERAL

- Interior woodwork in Alpi Walnut plywood
- Asburgo laminated floor
- Door to access to the cabins and bathroom without doorstep
- S/s handrail leather covered
- Stretched canvas covered ceiling in the saloon
- Fabric-covered forward saloon bulkhead
- Fabric-covered plywood ceiling in the owner cabin
- Polyester ceiling in the owner bathroom
- Polyester ceiling in the forward cabin
- Fabric-covered plywood ceiling in the aft cabin
- Polyester ceiling in the forward and aft bathroom
- Fabric-covered plywood on hull liner in cabins

STANDING HEADROOM

Cockpit:	2.20m / 7'3"
Saloon:	2.00m / 6'7"
Forward cabin:	2.00 m / 6'7"
Aft cabin:	1.90 m / 6'3"
Bathroom:	1.90 m / 6'3"

MATTRESSES AND UPHOLSTERY

- Marine mattresses made of multi-layer alveolar foam with several densities (tick. 130mm / 5in)
- Mattresses treatment: anti-microbial, anti-bacterial, non-allergenic, anti-dust mite
- Standard upholstery as indicated on Lagoon sample book
- Synthetic fabrics adapted to marine environment:
 - washable (40°C / 104°F)
 - U.V. resistant
 - water repellent, with anti-stain treatment
- Blinds and curtains:
 - Pleated fabric curtains for saloon
 - Blind model pleated-shade, blackout fabric for cabins
 - Roller blind in waterproof fabric for shower and head

3 cabins 3 bathroom



SALOON

Living area with:

- Sliding windows in aluminum, 3 sections, with locker for the access to the cockpit (2250 x 1900mm / 7'5" x 6'3"), blocking in different positions
- Wooden saloon table (Essential equipment)
 - Exchangeable with the coffee table (option)
 - Convertible in berth (option)
- 6 seats L-shaped bench on front starboard
- 1 fixed bench 2 seats in front of the L-shaped seating area
- 3 lockers under the bench (1 for the option air conditioning/heating)
- Stainless steel mast support strut
- 2 opening portholes in the front window (482x342mm / 1'7"x1'1")

CHART TABLE

- Large instrument console with panel to install the electronics that can be built in (finishing with soft touch paint color *Titanium*)
- 1 desk with 1 flap and 3 pencil holders
- Electric panel in the starboard companionway (Generator, water maker, AC, DC, inverter controls)

GALLEY

On starboard:

- U-shaped galley
- Laminated Volcanic Ash with molded wood countertop
- S/s sink with hot/cold mixer tap
- 1 door with a 25L / 7 US gal waste bin under the sink
- 1 cutlery drawer under the countertop
- 1 gas oven under the countertop
- 3 burner gas stove
- Storage niches under the stove

- Low storage cupboards with shelves, access from the saloon
- Open storage next to the entrance
- High storage cupboards
- Microwave (optional)

On portside:

- Low cupboard with:
 - Open storage
 - Fridge 130L / 34 US gal
 - Additional fridge with top access 100L / 26 US gal (option - not compatible with ice box)
 - Ice box with top access 100L / 26 US gal (option - not compatible with additional fridge)
 - TV on bulkhead (option)
- High storage cupboards

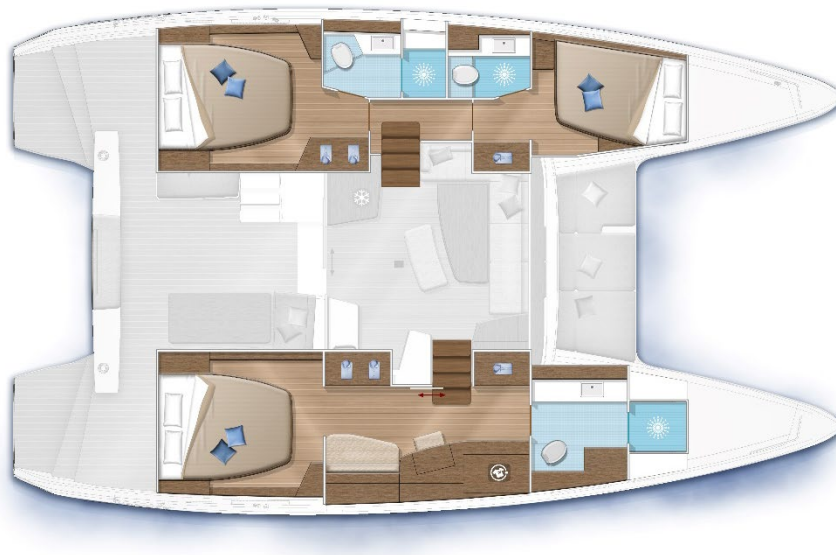

PORT HULL

Aft cabin

- Double bed with front and lateral access (2,05m x 1,80m / 6'9"x5'11")
- 2 bed nightstands
- 1 under bed drawer
- 1 wardrobe - inboard side
- 1 storage cupboard - inboard side
- 1 opening deck hatch with dorade box (T44 - 442x442mm / 1'5"x1'5")
- 1 opening hull porthole (T30 - 347x171mm / 1'2"x 7in)
- 1 fixed hull window in black PMMA (1200 x 420mm / 3'11"x1'5")
- 1 fixed hull window in black PMMA overlooking the back (230 x 1400mm / 9inx4'7")
- 1 opening hull porthole overlooking the back above the fixed window (347x171mm / 1'2"x 7") (essential equipment)

Aft bathroom

- Composite countertop
- Sink with hot/cold mixer tap
- High storage: 1 shelf, 1 mirror, 2 niches
- Low storage: 1 door, 2 shelves
- Separate shower with Plexiglas door
- Manual toilet
- 1 opening deck hatch with dorade box (T10 - 260x260mm / 10in x 10in)

Forward cabin

- Double bed with front and lateral access (2.00m x 1.20m x 1.30m at foot / 6'7"x3'11"x4'3")
- 1 under bed drawer
- 1 wardrobe - inboard side
- 1 storage niche with 1 shelf - inboard side
- 1 opening deck hatch with dorade box (T44 - 442x442mm / 1'5"x1'5")
- 1 opening hull porthole (T30 - 347x171mm / 1'2"x 7in)
- 1 fixed hull window in black PMMA (1200 x 420mm / 3'11"x1'5")

Forward bathroom

- Composite countertop
- Sink with hot/cold mixer tap
- High storage: 1 mirror, 2 niches
- Low storage: 1 door, 2 shelves
- Integrated shower
- Manual toilet
- 1 opening deck hatch with dorade box (T10 - 260x260mm / 10in x 10in)

STARBOARD HULL

Owner cabin

- Access from the saloon through a sliding door

Sleeping area:

- Double bed with front and lateral access (2,05m x 1,80m / 6'9"x5'11")
- 2 bed nightstands
- 1 under bed drawer
- 1 opening deck hatch with dorade box (T44 - 442x442mm / 1'5"x1'5")
- 1 opening hull porthole (T30 - 347x171mm / 1'2"x 7")
- 1 fixed hull window in black PMMA (1200 x 420mm / 3'11"x1'5")
- 1 fixed hull window in black PMMA overlooking the back (230 x 1400mm / 9in x 4'7")
- 1 opening hull porthole overlooking the back above the fixe window (347x171mm / 1'2"x 7") (essential equipment)

Working area:

- 1 cupboard with shelve behind the door - inboard side
- 1 wardrobe in front of the door - inboard side
- 1 sofa 2 seats - outboard side
- 1 desk with flap - outboard side

- Bookshelves – outboard side
- 1 large storage with:
 - Wardrobe in the upper part (washing machine option)
 - Cupboard with shelves in the lower part
- 2 opening deck hatches with dorade box (T10 - 260x260mm / 10in x 10in)

Owner bathroom

- Composite countertop
- Sink with hot/cold mixer tap
- High storage: 1 shelf, 1 mirror, 4 niches above the sink
- High storage: 1 door with shelves above the sink
- Low storage: 3 doors with shelves outboard side
- Manual toilet
- Separate shower with Plexiglas door
- 1 opening deck hatch with dorade box (T44 - 442x442mm / 1'5"x1'5")
- 1 opening hull porthole (T30 - 347x171mm / 1'2"x 7")
- 1 fixed hull window in black PMMA (1200 x 420mm / 3'11"x1'5")

4 cabins 4 bathroom



SALOON

Living room area with:

- Sliding windows in aluminum, 3 sections, with locker for the access to the cockpit (2250 x 1900mm / 7'5"x6'3"), blocking in different positions
- Wooden saloon table (Essential equipment)
 - Exchangeable with the coffee table (optional)
 - Convertible in berth (optional)
- 6 seat L-shaped bench on front starboard
- 1 fixed bench 2 seats in front of the L-shaped seating area
- 3 lockers under the bench (1 for the option air conditioning/heating)
- Stainless steel mast support strut
- 2 opening portholes in the front window (482x342mm / 1'7"x1'1")

CHART TABLE

- Large instrument console with panel to install the electronics that can be built in (finishing with soft touch paint color *Titanium*)
- 1 desk with 1 flap and 3 pencil holder
- Electric panel in the starboard companionway (Generator, water maker, AC, DC, inverter controls)

GALLEY

On starboard:

- U-shaped galley
- Laminated Volcanic Ash with molded wood countertop
- S/s sink with hot/cold mixer tap
- 1 door with a 25L / 7 US gal waste bin under the sink
- 1 cutlery drawer under the countertop
- 1 gas oven under the countertop
- 3 burner gas stove
- Storage niches under the stove
- Low storage cupboards with shelves, access from the saloon

- Open storage next to the entrance
- High storage cupboards
- Microwave (optional)

On port side:

- Low cupboard with:
 - Open storage
 - Fridge 130L / 34 US gal
 - Additional fridge with top access 100L / 26 US gal (option - not compatible with ice box)
 - Ice box with top access 100L / 26 US gal (option - not compatible with additional fridge)
 - TV on bulkhead (option)
- High storage cupboards



PORT HULL

Aft cabin

- Double bed with front and lateral access (2.05m x 1.80m / 6'9"x5'11")
- 2 bed nightstands
- 1 under bed drawer
- 1 wardrobe - inboard side
- 1 storage cupboard - inboard side
- 1 opening deck hatch with dorade box (T44 - 442x442mm / 1'5"x1'5")
- 1 opening hull porthole (T30 - 347x171mm / 1'2"x 7in)
- 1 fixed hull window in black PMMA (1200 x 420mm / 3'11"x1'5")
- 1 fixed hull window in black PMMA overlooking the back (230 x 1400mm / 9inx4'7")
- 1 opening hull porthole overlooking the back above the fixe window (347x171mm / 1'2"x 7") (essential equipment)

Aft bathroom

- Composite countertop
- Sink with hot/cold mixer tap

- High storage: 1 shelf, 1 mirror, 2 niches
- Low storage: 1 door, 2 shelves
- Separate shower with Plexiglas door
- Manual toilet
- 1 opening deck hatch with dorade box (T10 - 260x260mm / 10in x 10in)

Forward cabin

- Double bed with front and lateral access (2.00m x 1.20m x 1.30m at foot / 6'7"x3'11"x4'3")
- 1 under bed drawer
- 1 wardrobe – inboard side
- 1 storage niche with 1 shelf – inboard side
- 1 opening deck hatch with dorade box (T44 - 442x442mm / 1'5"x1'5")
- 1 opening hull porthole (T30 - 347x171mm / 1'2"x 7")
- 1 fixed hull window in black PMMA (1200 x 420mm / 3'11"x1'5")

Forward bathroom

- Composite countertop
- Sink with hot/cold mixer tap
- High storage: 1 mirror, 2 niches
- Low storage: 1 door, 2 shelves
- Integrated shower
- Manual toilet
- 1 opening deck hatch with dorade box (T10 - 260x260mm / 10" x 10")

STRABOARD HULL

Aft cabin

- Double bed with front and lateral access (2.05m x 1.80m / 6'9"x5'11")
- 2 bed nightstands
- 1 under bed drawer
- 1 wardrobe – inboard side
- 1 opening deck hatch with dorade box (T44 - 442x442mm / 1'5"x1'5")
- 1 opening hull porthole (T30 - 347x171mm / 1'2"x 7")
- 1 fixed hull window in black PMMA (1200 x 420mm / 3'11"x1'5")
- 1 fixed hull window in black PMMA overlooking the back (230 x 1400mm / 9inx4'7")
- 1 opening hull porthole overlooking the back above the fixe window (347x171mm / 1'2"x 7") (essential equipment)

Aft bathroom

- Composite countertop
- Sink with hot/cold mixer tap
- High storage: 1 shelf, 1 mirror, 2 niches
- Low storage: 1 door, 2 shelves
- Separate shower with Plexiglas door
- Manual toilet
- 1 opening deck hatch with dorade box (T10 - 260x260mm / 10" x 10")

Forward cabin

- Double bed with front and lateral access (2.00m x 1.20m x 1.30m at foot / 6'7"x3'11"x4'3")
- 1 under bed drawer
- 1 wardrobe – inboard side
- 1 storage niche with 1 shelf – inboard side
- 1 opening deck hatch with dorade box (T44 - 442x442mm / 1'5"x1'5")
- 1 opening hull porthole (T30 - 347x171mm / 1'2"x 7in)
- 1 fixed hull window in black PMMA (1200 x 420mm / 3'11"x1'5")

Forward bathroom

- Composite countertop
- Sink with hot/cold mixer tap
- High storage: 1 mirror, 2 niches
- Low storage: 1 door, 2 shelves
- Integrated shower
- Manual toilet
- 1 opening deck hatch with dorade box (T10 - 260x260mm / 10" x 10")



MARINE SERVICENTER

YACHT SALES & SERVICE SINCE 1977

Seattle Sales & Service
2442 Westlake Ave N
206.323.2405

Bellingham Sales
1801 Roeder Ave #128
360.770.0180

San Diego Sales & Service
2700 Shelter Island Dr.
619.733.0559

marinesc.com | info@marinesc.com